

REGIONAL TRANSIT ISSUE PAPER

Agenda Item No.	Board Meeting Date	Open/Closed Session	Information/Action Item	Issue Date
15	01/23/12	Open	Information	12/16/11

Subject: Presentation of SSCP2 Artwork Conceptual Design Proposals

ISSUE

To review the artwork proposals for the South Sacramento Corridor Phase 2 Project

RECOMMENDED ACTION

Information only. The artwork contracts will be within the General Manager's limit of authority.

FISCAL IMPACT

None. Information only.

DISCUSSION

The South Sacramento Corridor Phase 2 Project budget includes design, fabrication and installation of artwork at each station (Franklin, Center Parkway, and Cosumnes River College Stations). RT has also allocated an artwork budget for the Cosumnes River Boulevard Flyover, in keeping with RT's practice over the past decade (e.g. artwork installed at Florin Road, Watt Avenue and Sunrise Grade Separations). The Morrison Creek Station construction will be deferred, therefore no artwork is planned for that location at this time.

The total budget for SSCP2 artwork is \$257,000. The budget for each of the four artwork pieces is \$56,000, of which \$4,000 is for conceptual design (completed), \$4,000 is for final design, and \$48,000 is for fabrication and installation of artwork. RT is also paying \$33,000 to the Sacramento Metropolitan Arts Commission (SMAC) Art in Public Places Program staff for artwork management services on the project.

Attachments:

Power Point Presentation (Attachment 1)

APP staff report to the Arts Commission for Franklin and Center Parkway Stations (Attachment 2)

APP staff report to the Arts Commission for CRB Flyover and CRC Station (Attachment 3)

Approved:

Presented:

Final 1/17/12

General Manager/CEO

Senior Architect

C:\Temp\BCL Technologies\NitroPDF6\@BCL@E40C9C0D\@BCL@E40C9C0D.doc



SOUTH SACRAMENTO CORRIDOR PHASE 2 PROJECT

Artwork Conceptual Design Proposals

SSCP2 Artwork Locations

- Morrison Creek Station (deferred)
- Franklin Station
- Center Parkway Station
- Cosumnes River College Station
- Cosumnes River Boulevard Flyover
- Total artwork budget: \$257,000

South Sacramento Corridor Phase 2 Project

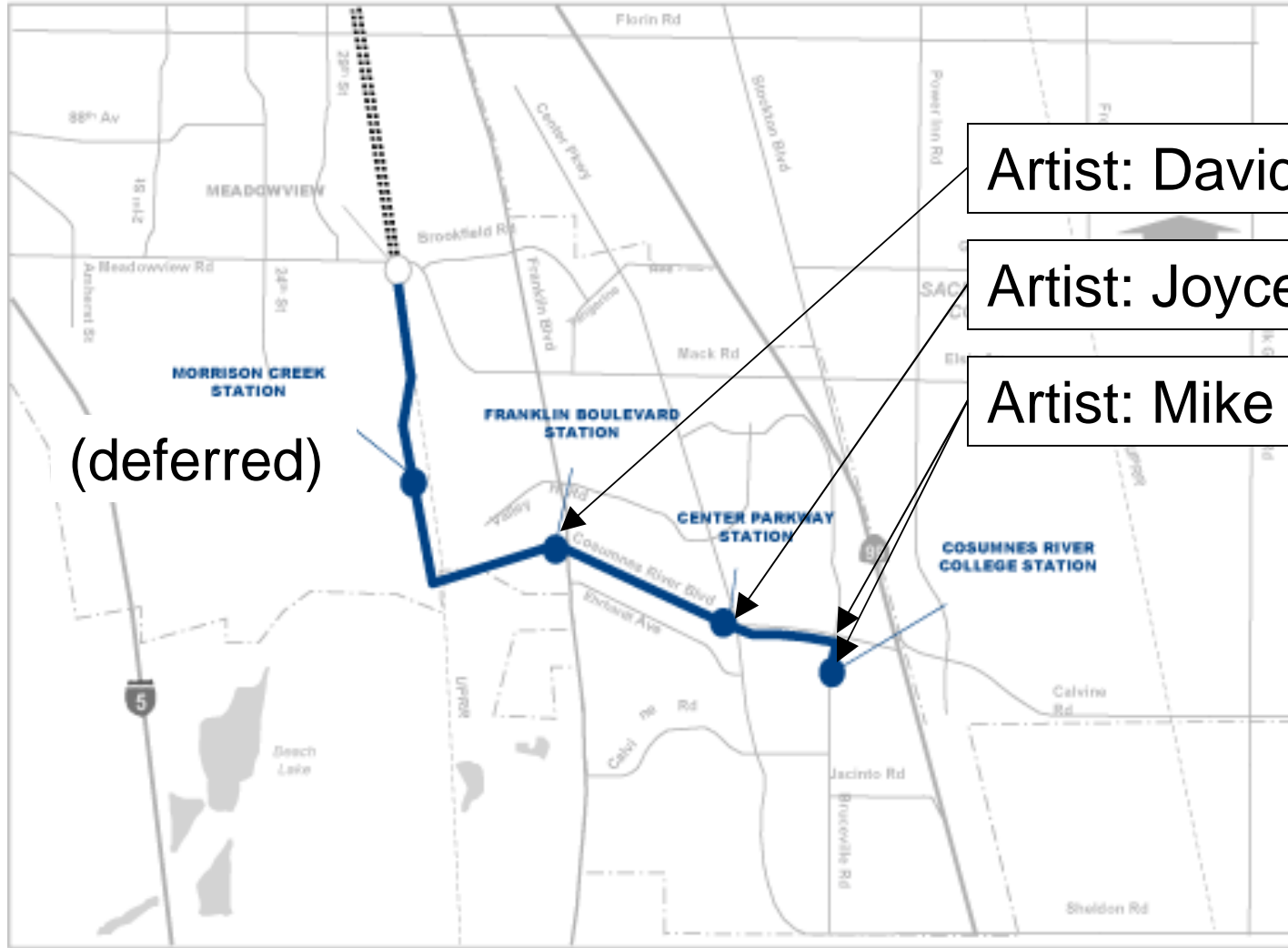

Artist: David Best

Artist: Joyce Hsu

Artist: Mike Ross

Franklin Station Artwork

By David Best

- Concept: Gateway and beacon

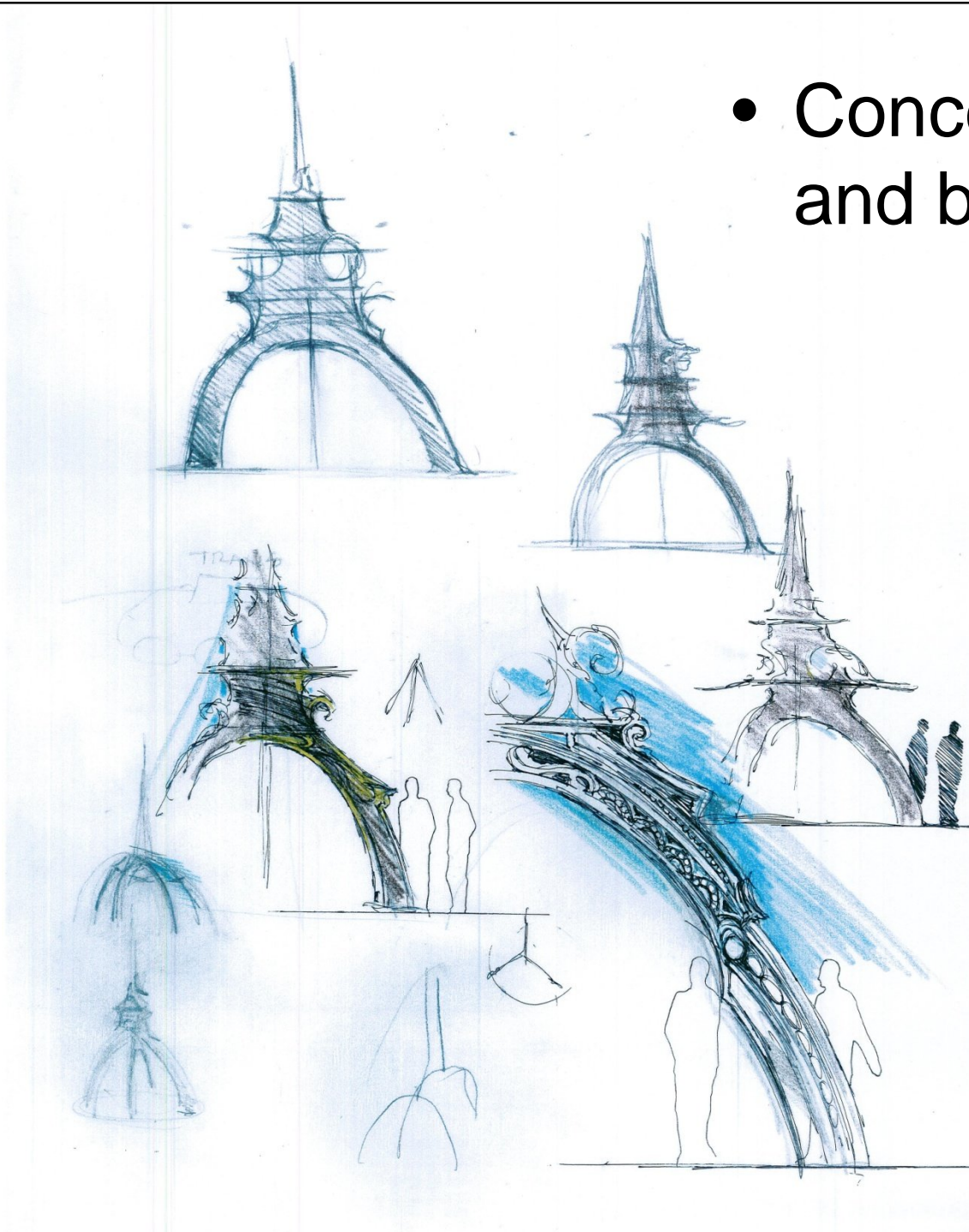

- Archway
- To welcome and honor the diversity and hard work of the community.



- While the shape is reminiscent of a temple, it is not meant to represent any particular religion or culture.
- Instead, it is meant to broadly welcome all cultures and invite individual interpretation.

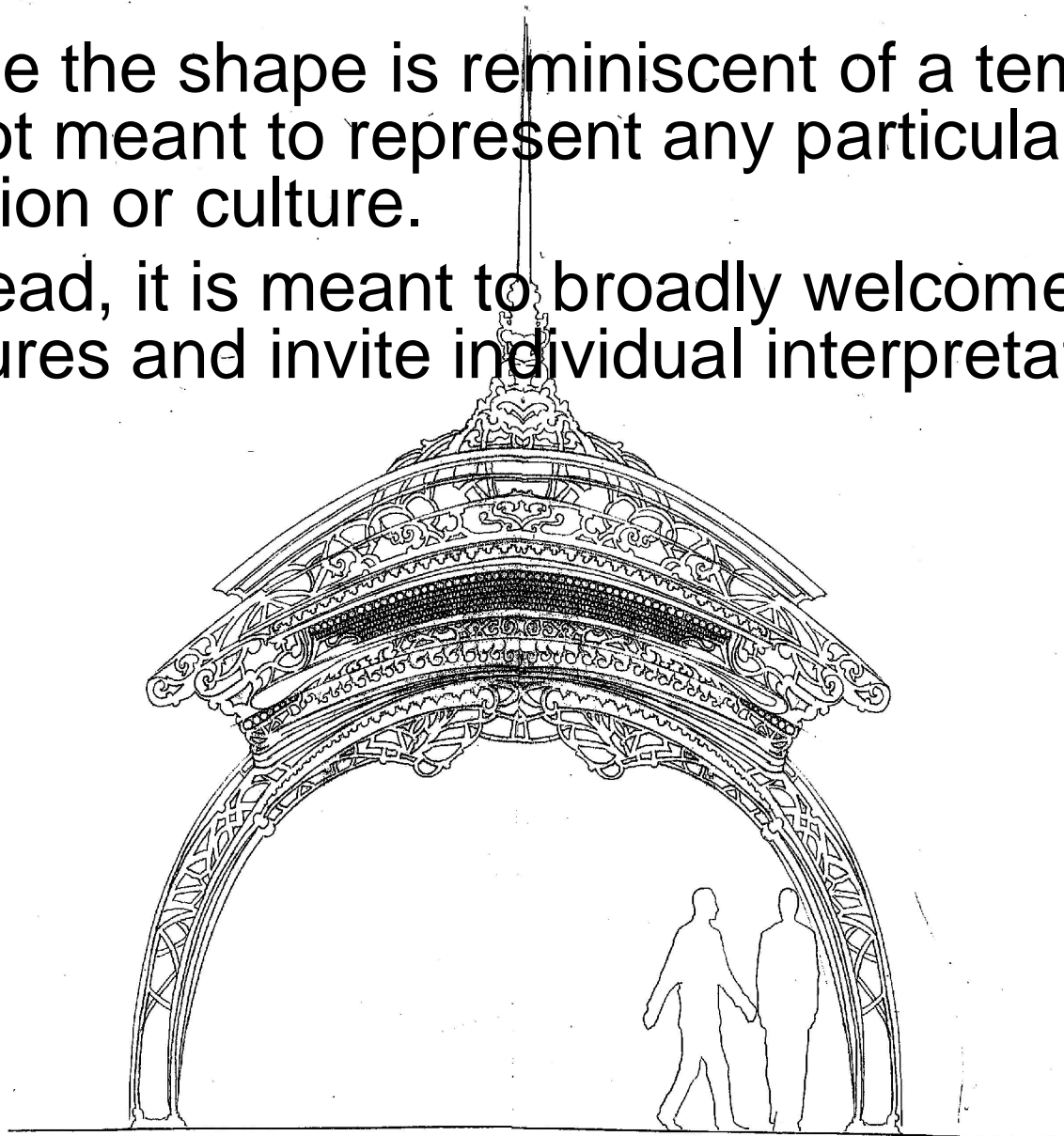

- Material:
- Patina:
- Highlights
- Areas touched:

- Plasma-cut steel
- Bronze (majority)
 - Silver tone
 - Brass finish

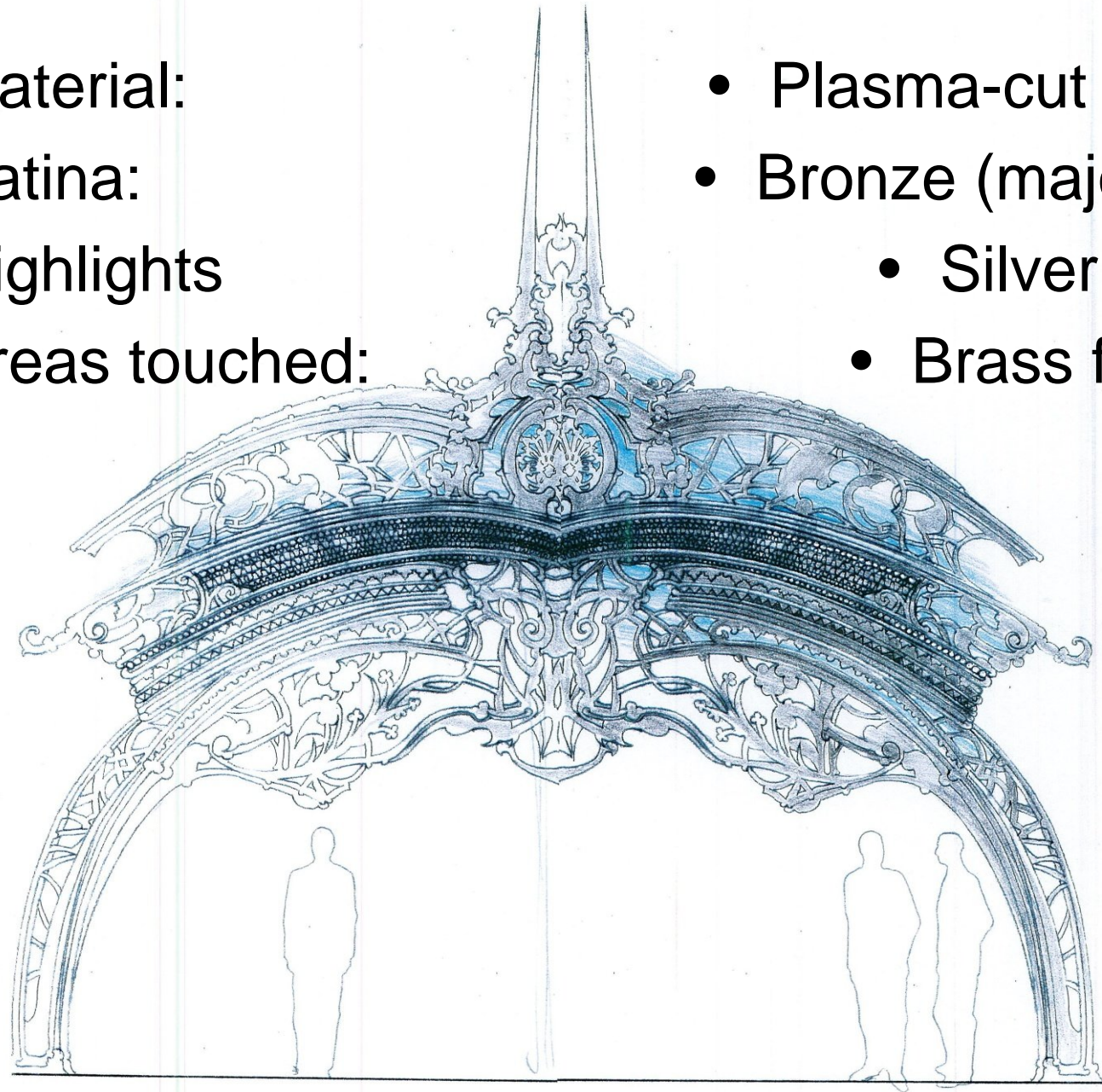

- Height: 30'
- Opening:
8' high
12' wide

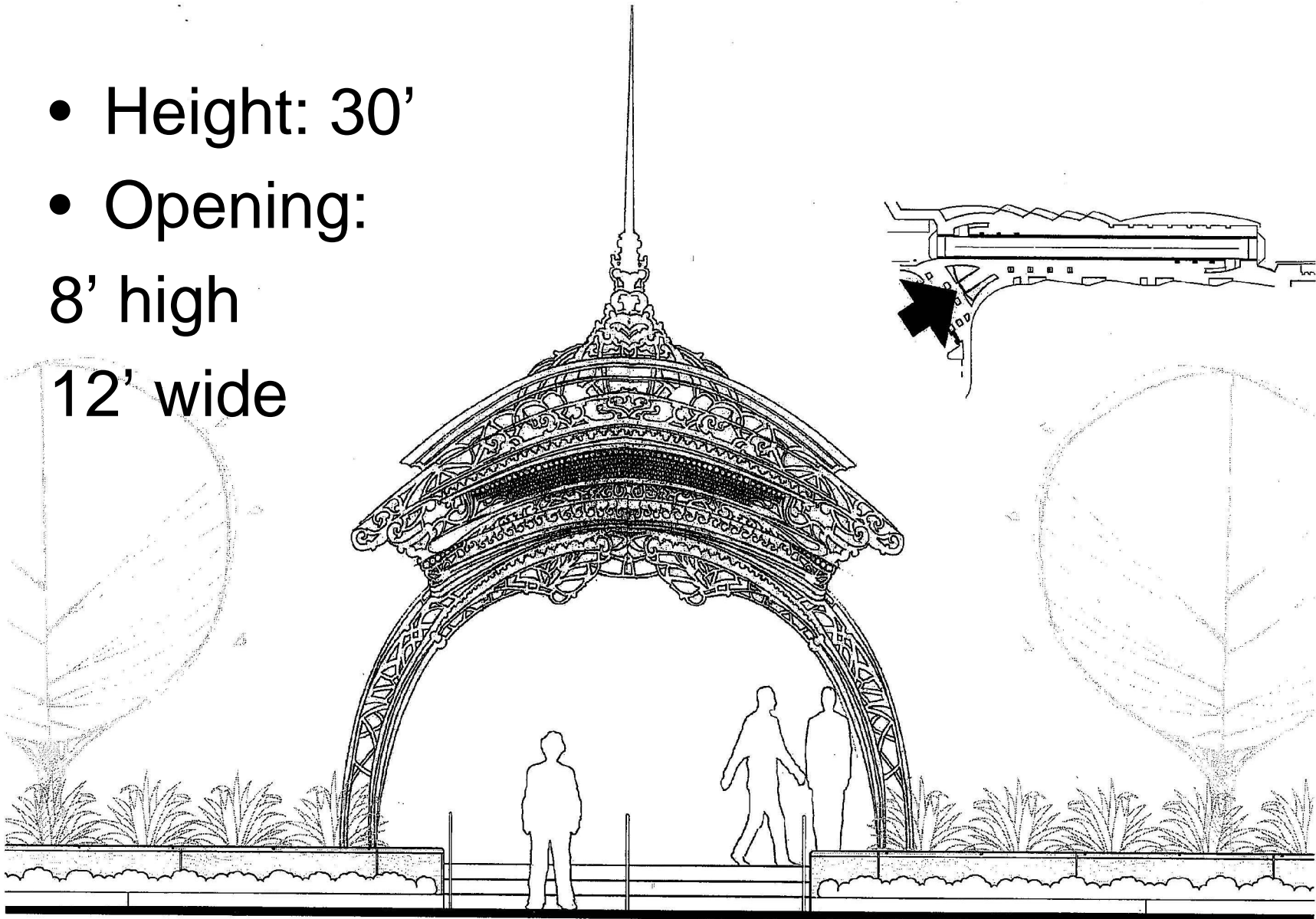

The HLA Group
Landscape Architects & Planners, Inc.
1050 Twentieth Street, Suite 200
Sacramento, California 95811
916.447.7400 / 916.447.8270 fax
www.hlagroup.com

Artwork Location
Franklin Light Rail Station
Sacramento, California

October, 2011
Scale: 3/32" = 1'-0"

Center Parkway Station Artwork

Migration
By Joyce Hsu

- Proposed location:
Main shelter
- Alternate locations:
Plaza or TBD

Lepidoptera migration is a biological phenomenon whereby populations of butterflies or moths migrate over long distances to areas where they cannot settle for long periods of time. It refers to the act of moving from one place to another in a manner that is seasonally determined and predictable.

migration

Regional Transit South Sacramento Corridor Phase 2
Center Parkway Station Public Art Concept Proposal

2011

HSU SW Joyce

1201 pine street, unit 346, oakland, ca 94707 | naabee@gmail.com | 415.652.6322

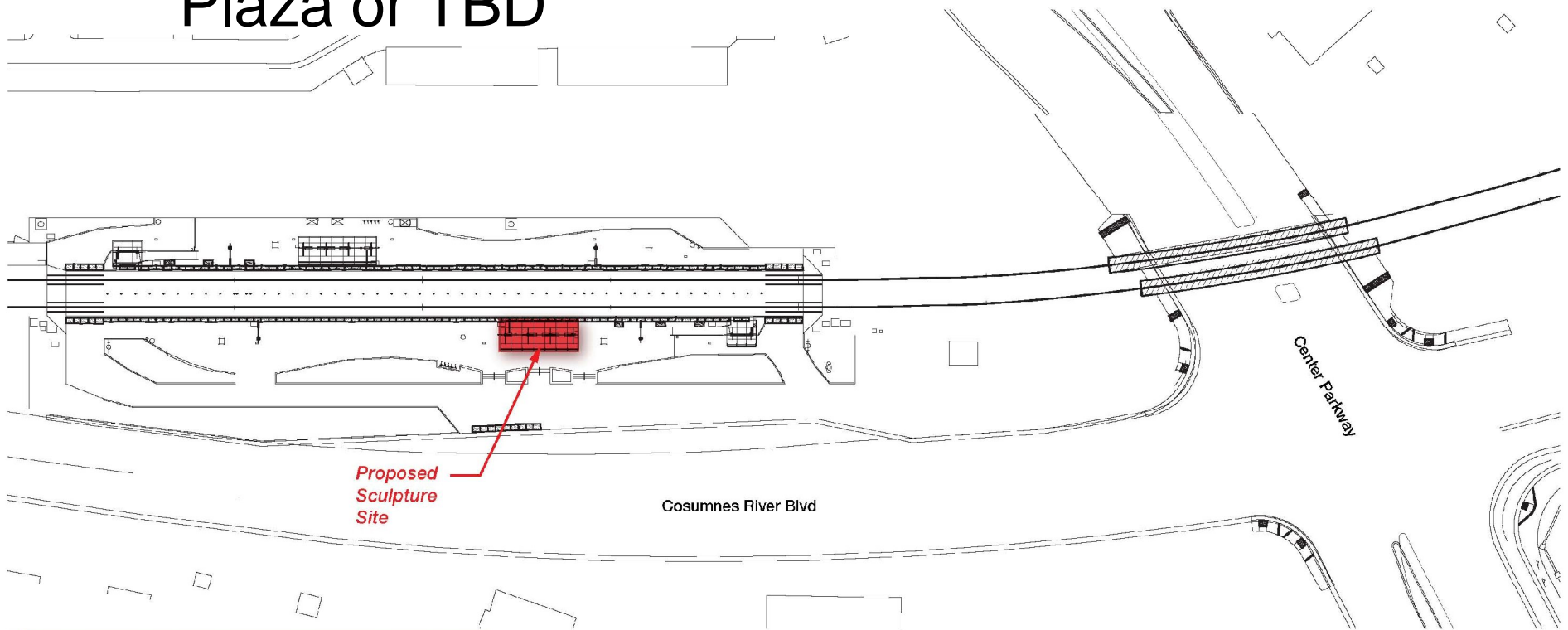

SITE PLAN scale 1:50



Lepidoptera migration is a biological phenomenon whereby populations of butterflies or moths migrate over long distances to areas where they cannot settle for long periods of time. It refers to the act of moving from one place to another in a manner that is seasonally determined and predictable.

migration

Regional Transit South Sacramento Corridor Phase 2
Center Parkway Station Public Art Concept Proposal

2011

KINGSWAY / ROYAL ALEX LRT
HSU SW Joyce

1201 pine street, unit 346, oakland, ca 94707 | naabee@gmail.com | 415.652.6322

monarch butterfly

The total time frame for one butterfly's life cycle (one generation) is about 6-8 weeks . . . egg, caterpillar, chrysalis, butterfly. It grows inside the egg for about 4 days. It then munches milkweed and grows as a monarch caterpillar (larvae) for about 2 more weeks. The caterpillar's life inside the chrysalis (pupa) lasts about 10 days and its wonderful life as an adult butterfly lasts from 2 - 6 weeks.

February/March - hibernating monarchs in Mexico and southern California reawaken, become active, find a mate, begin the flight northward and lay their eggs. Finally they die. These special monarchs have lived about 4-5 months through the long winter.

March/April -the **1st generation** monarchs are born -egg, caterpillar, chrysalis, adult butterfly;

May/June - the **2nd generation** is born - egg, caterpillar, chrysalis, adult butterfly;

July/August - the **3rd generation** is born - egg, caterpillar, chrysalis, adult butterfly;

Sept/Oct - the **4th generation** is born - egg, caterpillar, chrysalis, adult butterfly . . . but THIS generation does not die. It MIGRATES south and lives 6-8 months in Mexico or Southern California. They begin awakening and mating in February/March of the NEXT SPRING, and then lay their eggs! Withered and tattered from their migration and hibernation . . . they finally die.

Lepidoptera migration is a biological phenomenon whereby populations of butterflies or moths migrate over long distances to areas where they cannot settle for long periods of time. It refers to the act of moving from one place to another in a manner that is seasonally determined and predictable.

migration

Regional Transit South Sacramento Corridor Phase 2
Center Parkway Station Public Art Concept Proposal

2011

HSU | SW | Joyce

1201 pine street, unit 346, oakland, ca 94707 | naabee@gmail.com | 415.652.6322

migration

My proposed public art for the Center Parkway station composed of three free standing aluminum Monarch butterflies mounted on steel structural support on the edge of the station roof.

Monarch butterflies are noted for their lengthy annual migration. In North America they make massive southward migrations starting in August until the first frost. Sacramento area has been part of this annual natural spectacle. Like the Monarch butterflies, thousands of commuters travel daily between one's place of residence and place of work or study.

The average commuter may spend up to five hours a week in a transit station. The occasional discomfort and crowdedness of commuting can often overshadowing the convenience and efficiency of transit system. We often wish for a better, more personal experience.

What if the commuters are presented with Monarch butterflies at the entrance of the station? Not only are these butterflies aesthetically intriguing, they are also a symbol for resilience. "Migration" is a sculpture that celebrates our everyday journey and to remind us all the simple beauty of our everyday life.

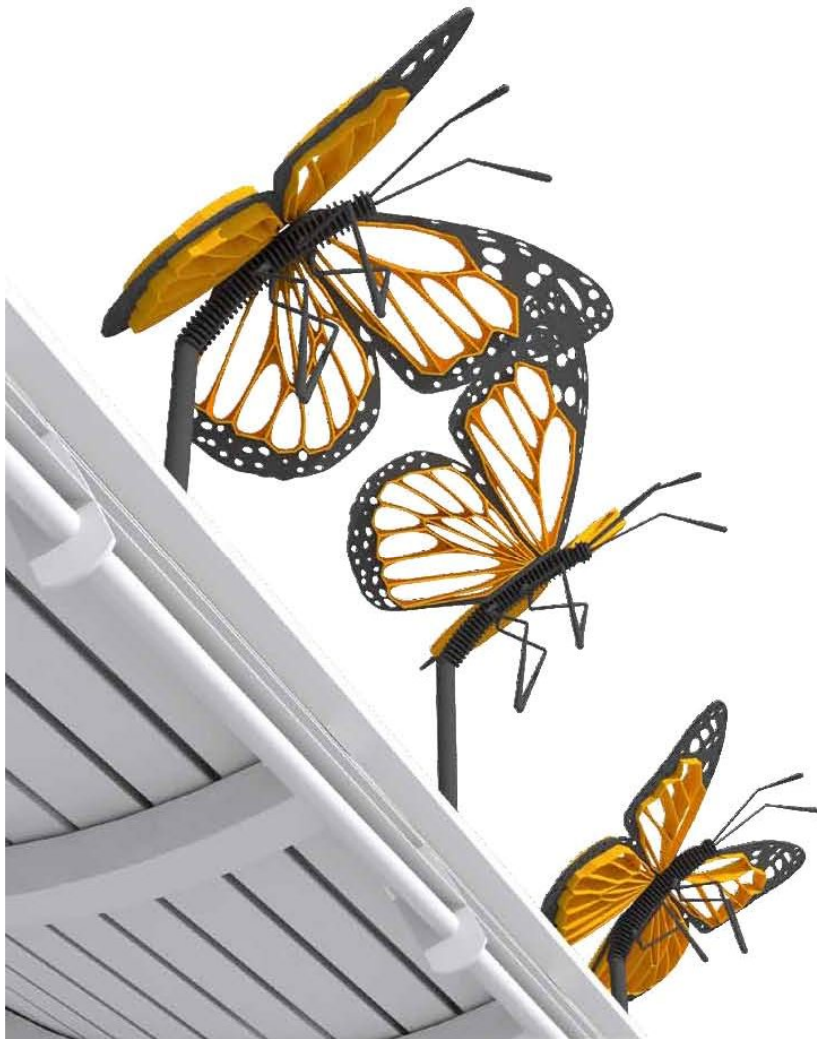

INTRODUCTION

- Daily commuter migration is like the annual migration of Monarch butterflies

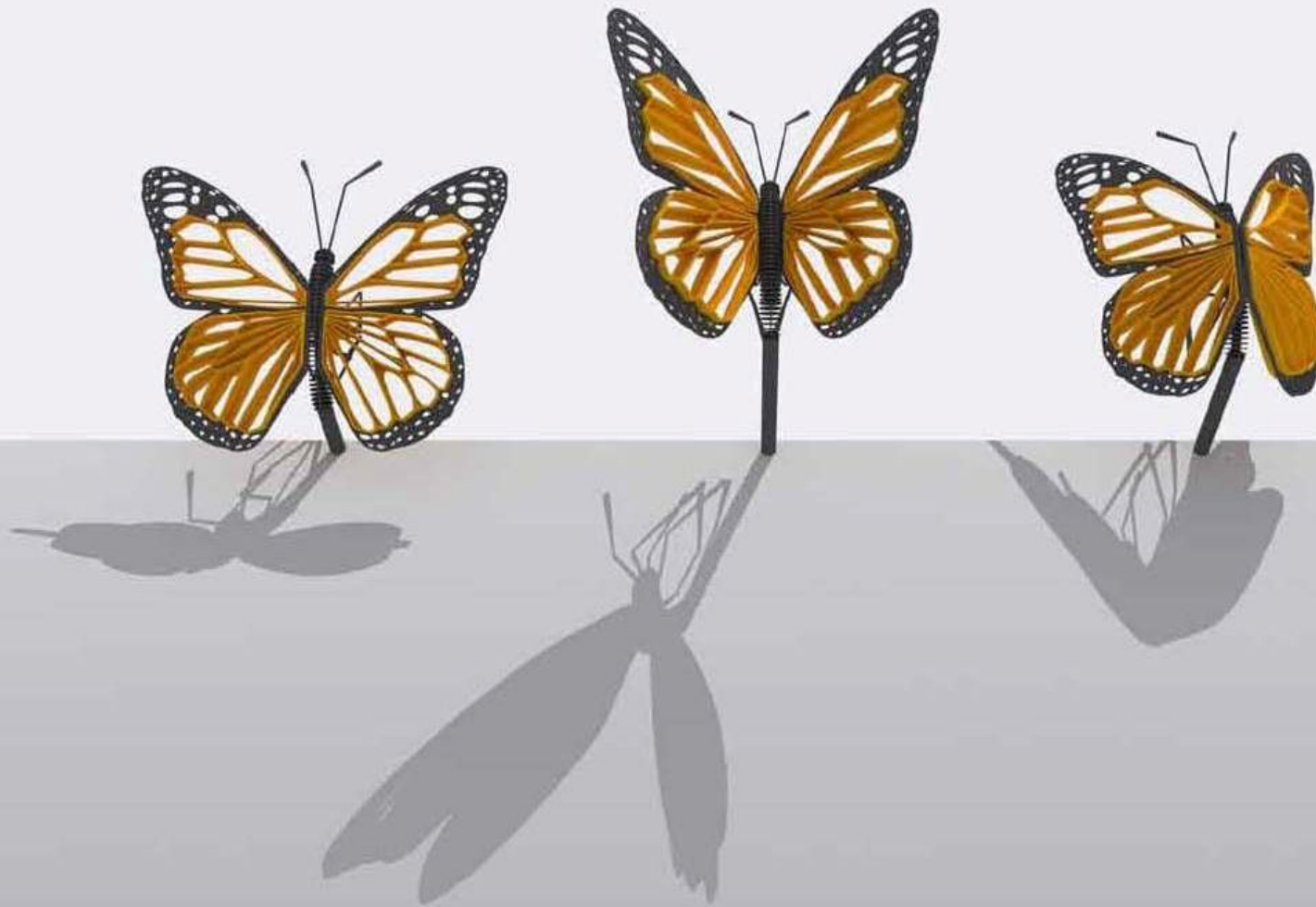

- Shadows are part of the concept.

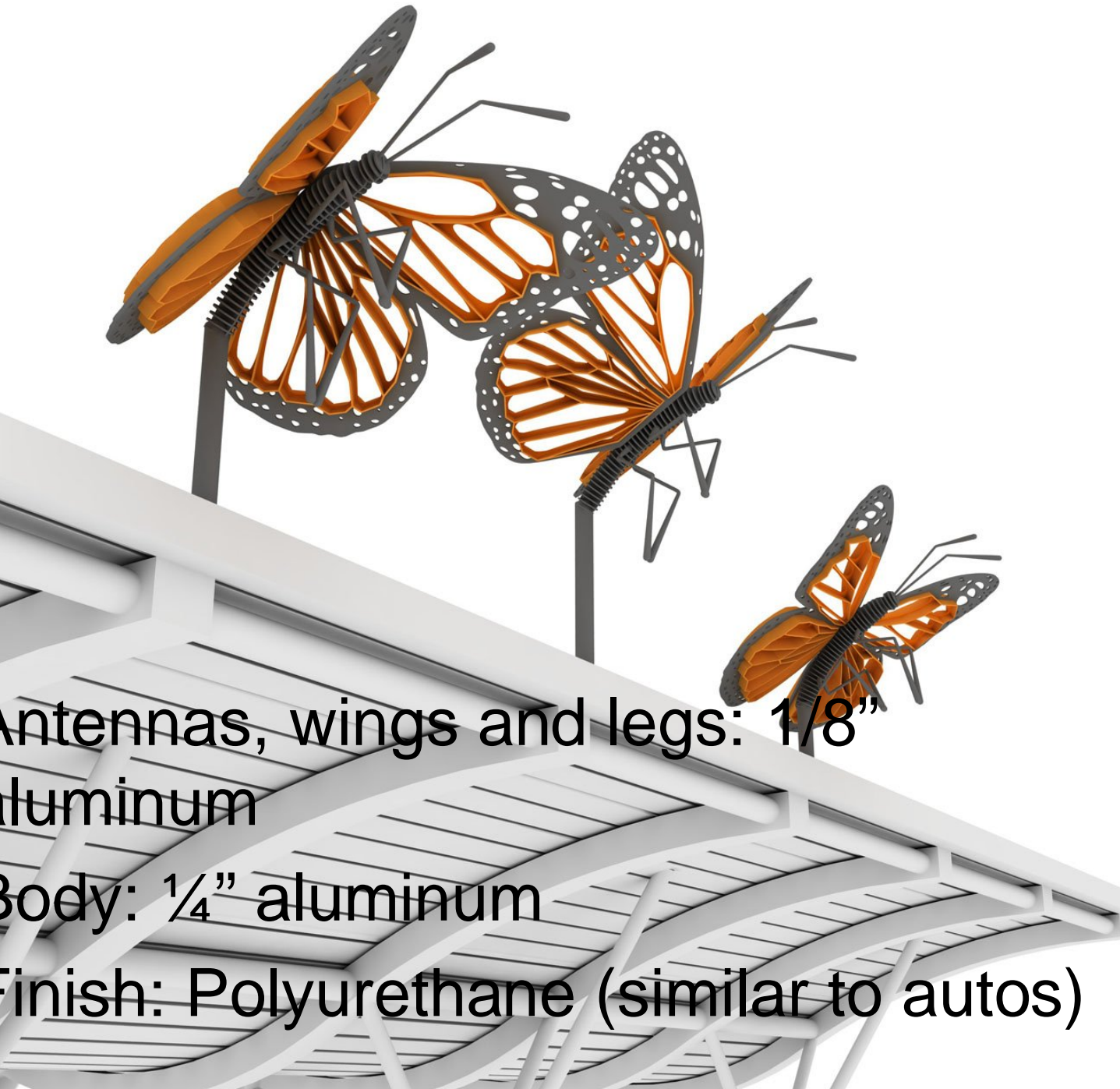
- 
- Antennas, wings and legs: 1/8" aluminum
 - Body: 1/4" aluminum
 - Finish: Polyurethane (similar to autos)

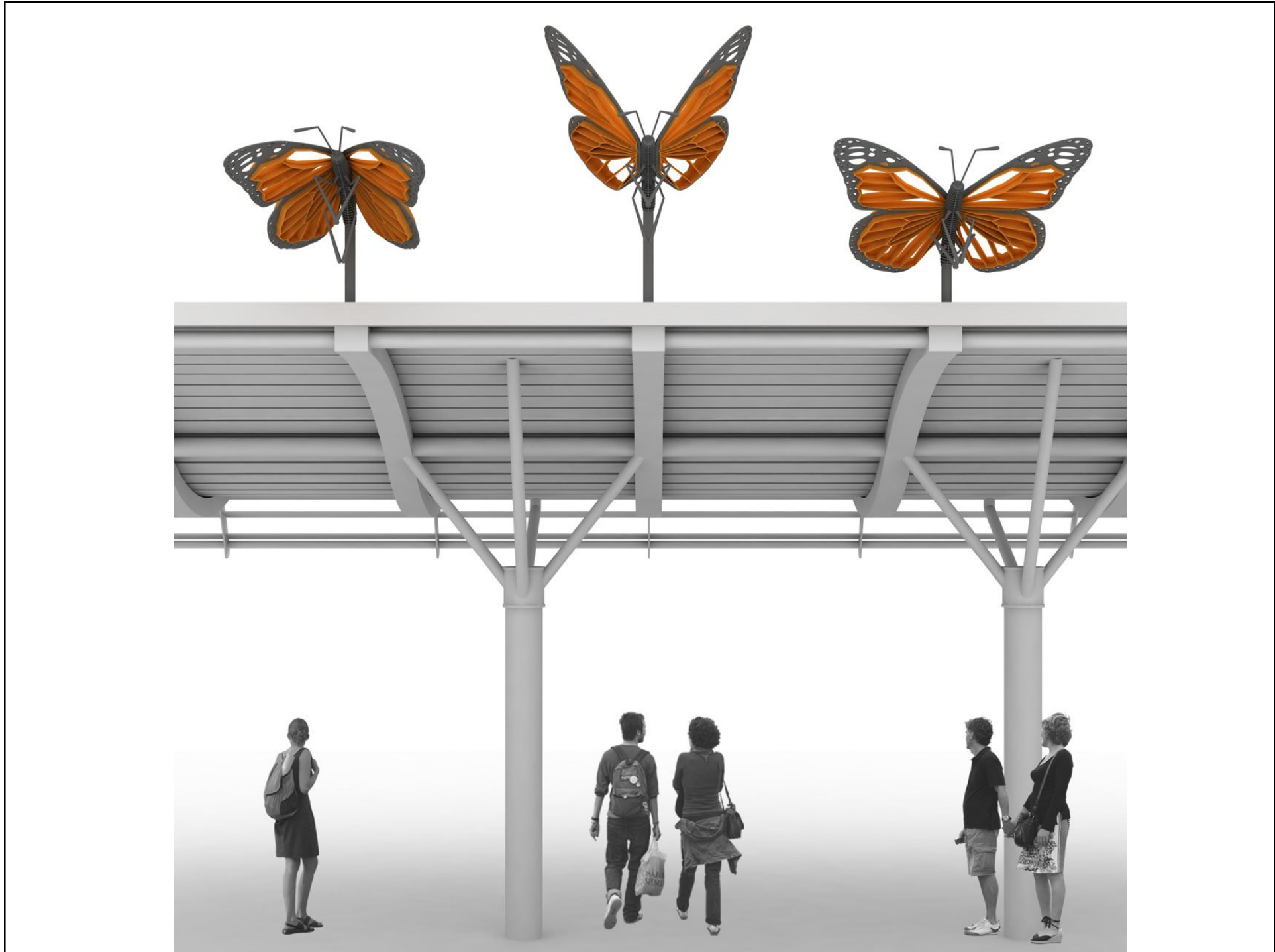



- 4'-8" wide
- 3'-6" long
- 2'-9" posts





migration

Regional Transit South Sacramento Corridor Phase 2
Center Parkway Station Public Art Concept Proposal

2011

CENTER PARKWAY STATION
HSU SW Joyce

Celebrate:

- Journeys taken every day
- Simple beauty of everyday life

Perspective View

RENDERING



Cosumnes River College Station Artwork

By Mike Ross

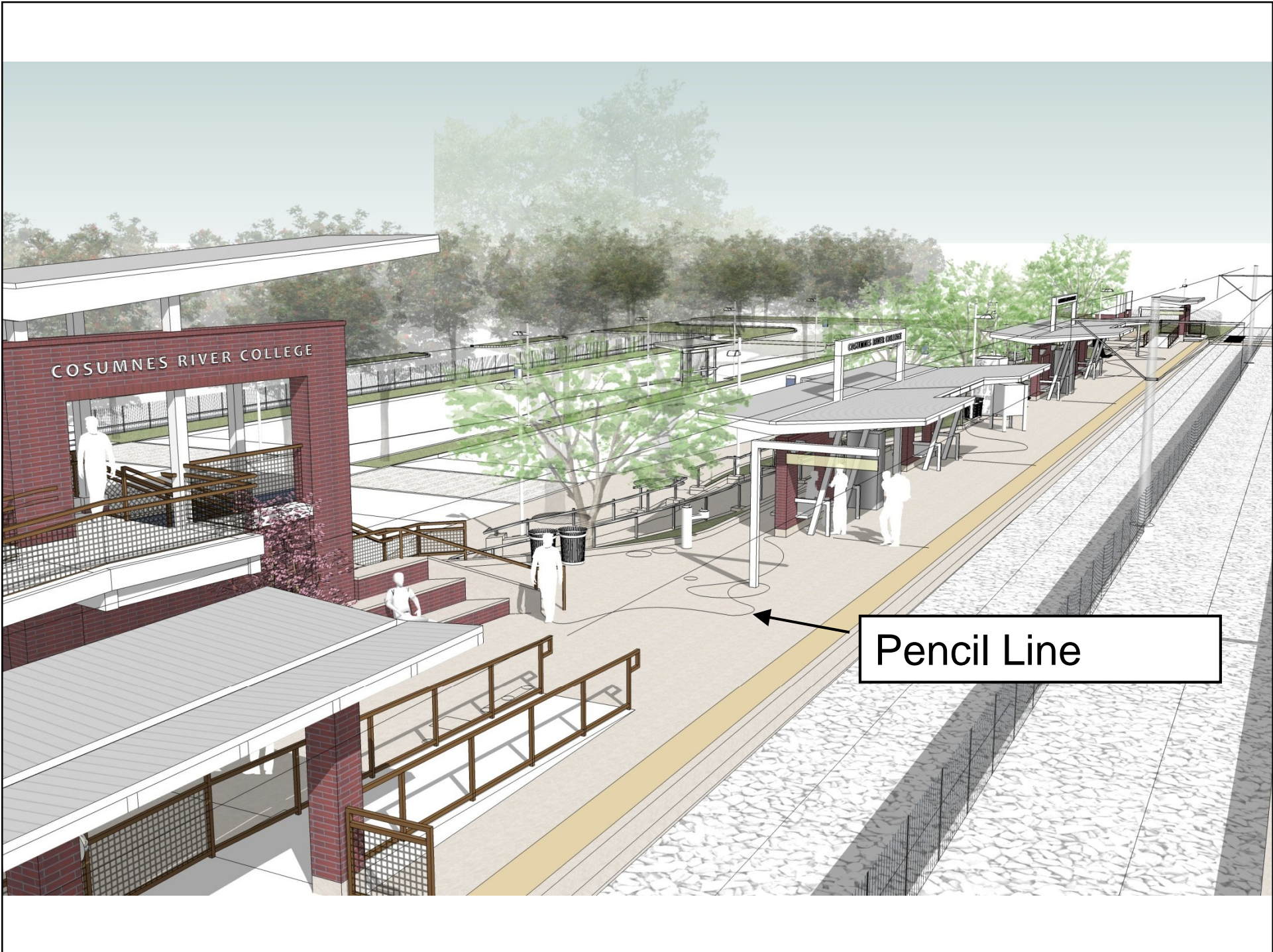

Pencil Line



- Curvilinear
- Material: Stainless steel or anodized aluminum

- Relates to sine waves of varying frequencies

- Prompts exploration along the length of line

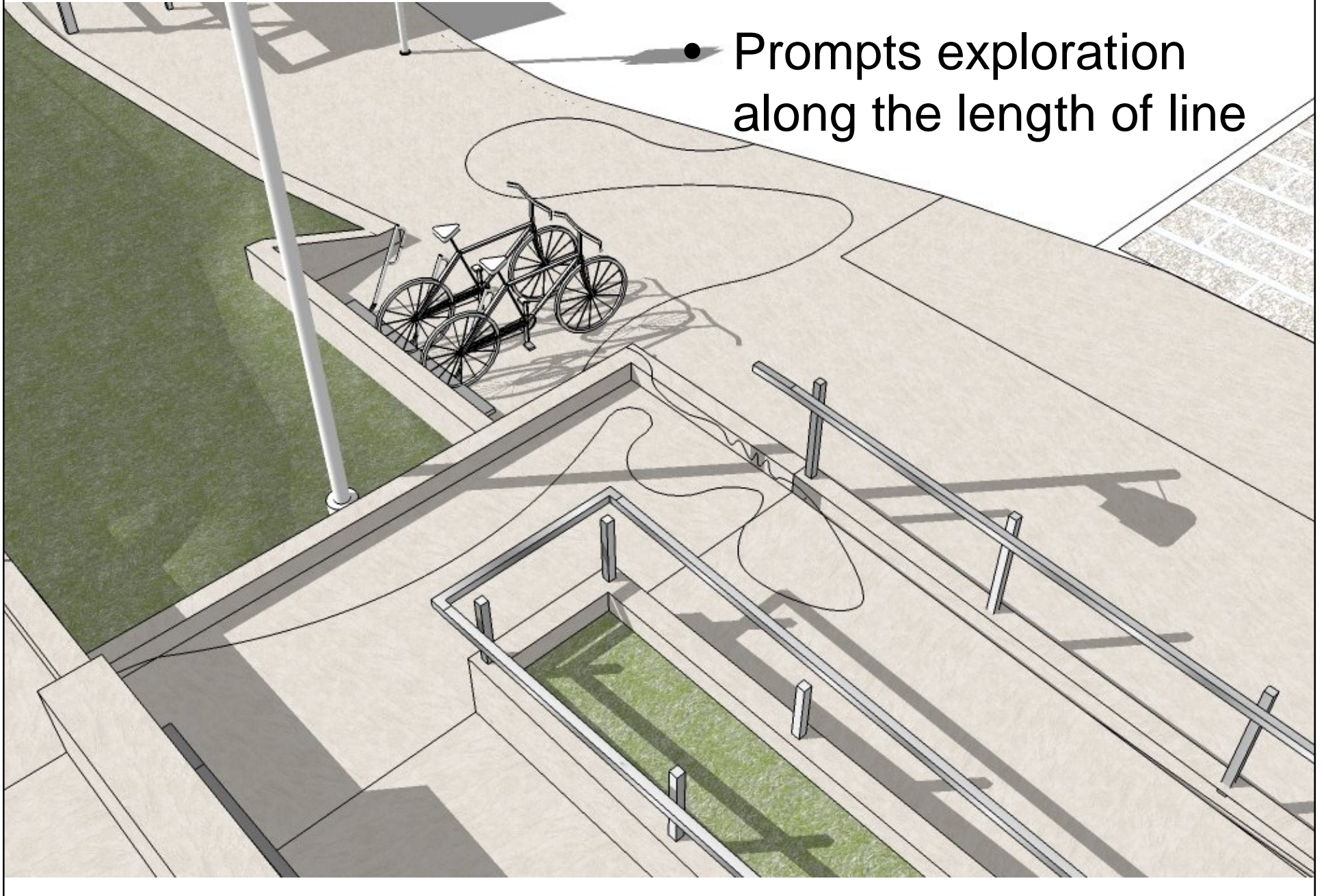



- Transitions to different materials
- Method of installation will vary

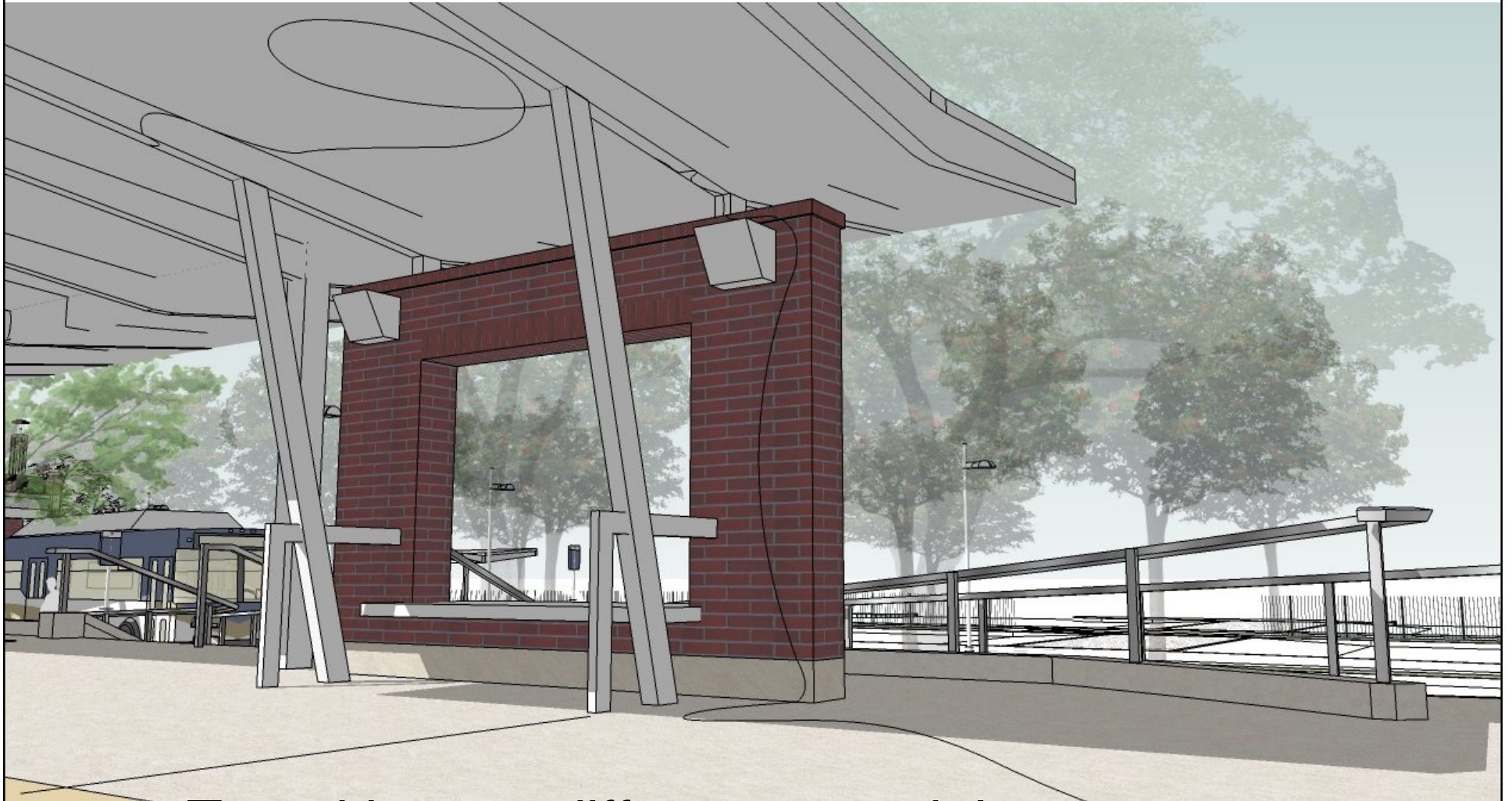

- Transitions to different materials
- Method of installation will vary



Cosumnes River Blvd. Flyover Artwork

By Mike Ross

Original proposal

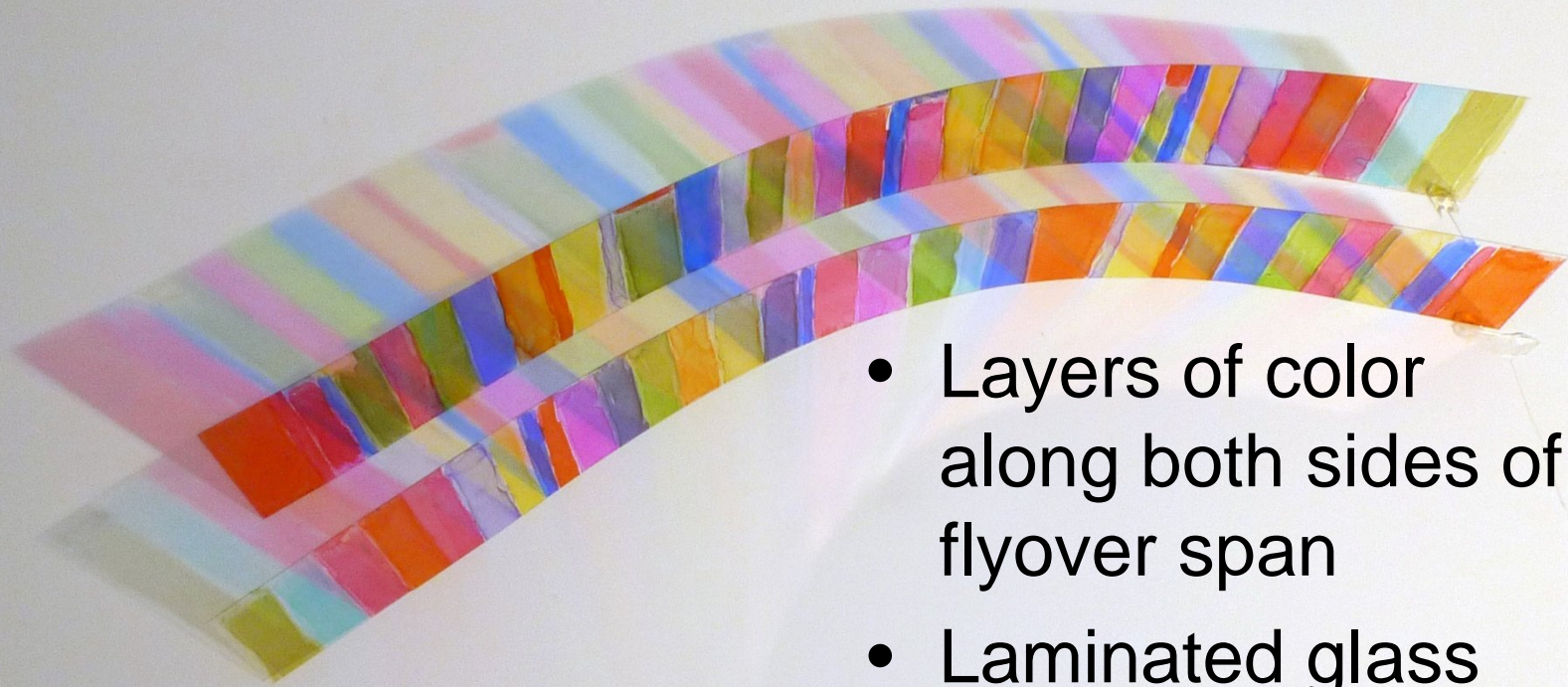

- Layers of color along both sides of flyover span
- Laminated glass was too expensive

Revised proposal - idea

Fence

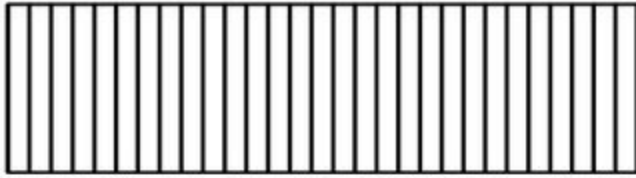

Vary:
Spacing



Shape

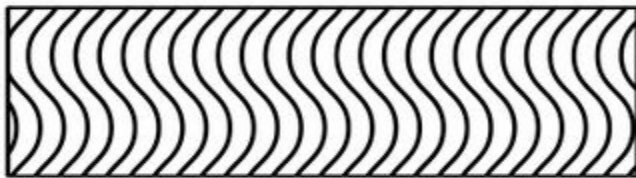

Height



Rotation

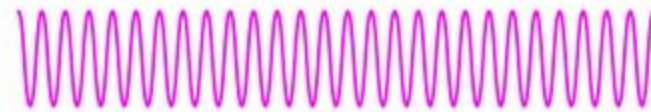
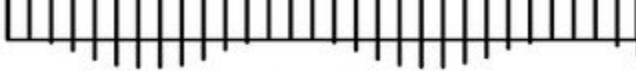

Color

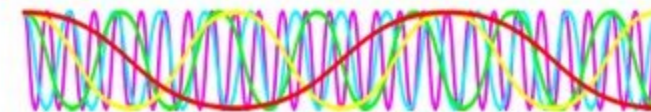
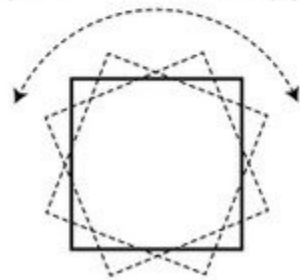

- Sine waves combined to generate patterns

- Combined patterns in two layers generate a moiré effect

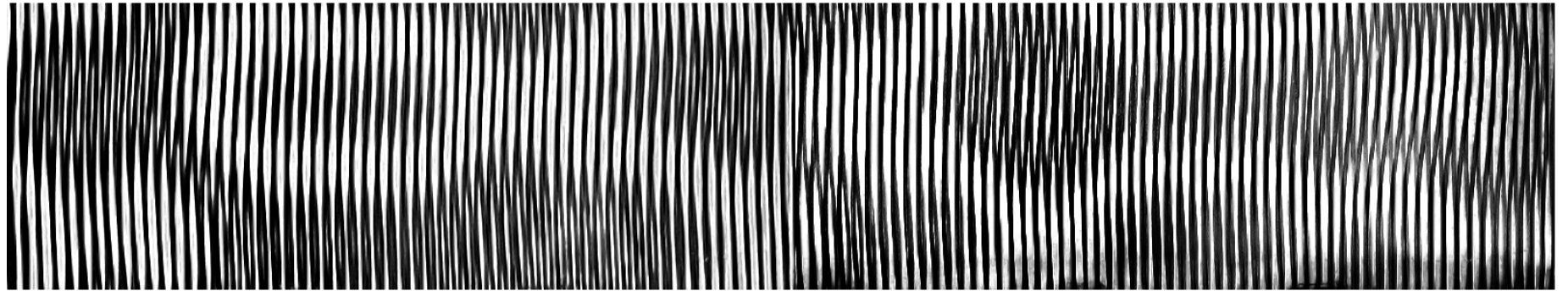

Example of moiré effect:

- School in Brisbane, Australia



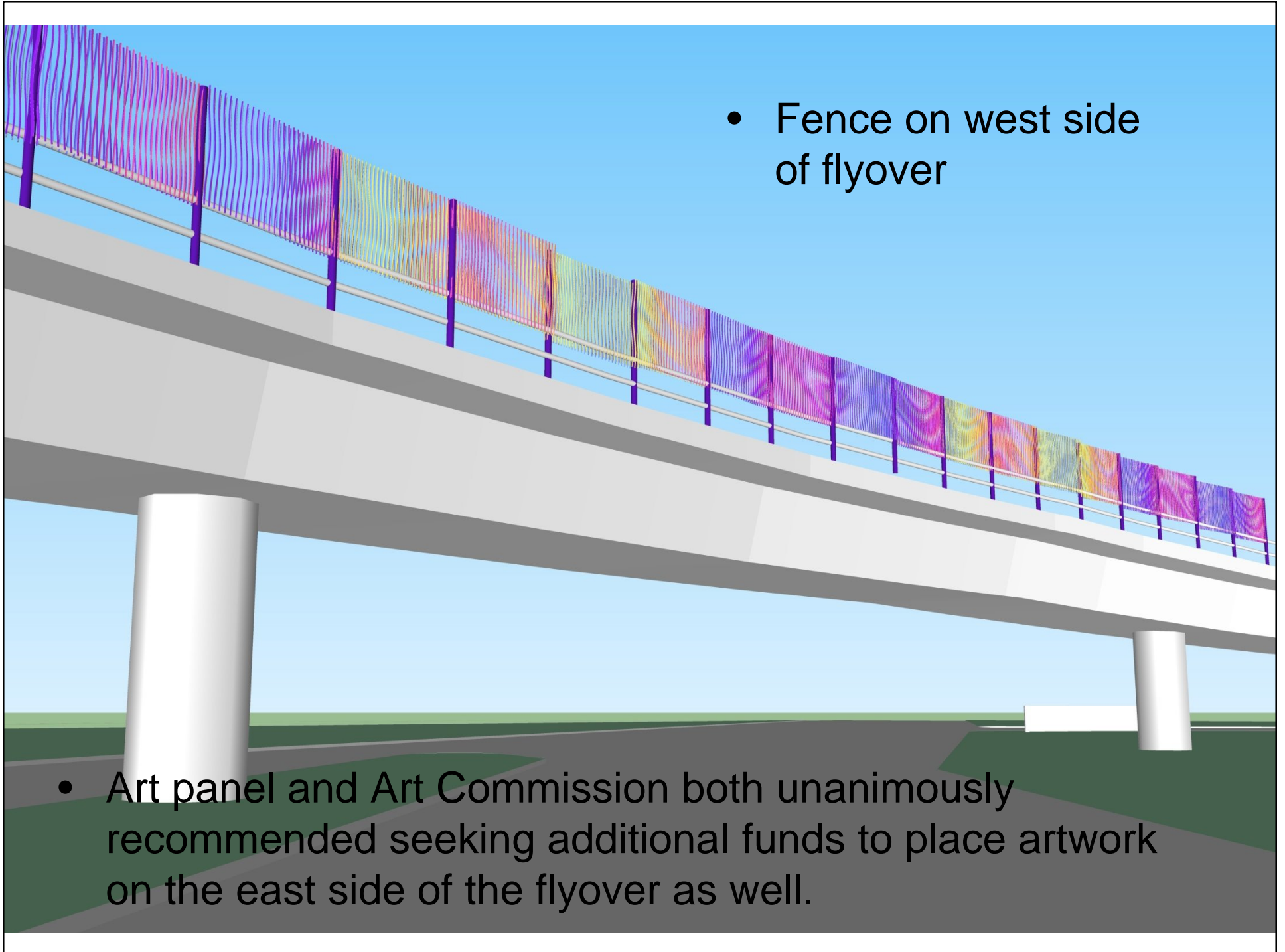

- Fence on west side of flyover

- Art panel and Art Commission both unanimously recommended seeking additional funds to place artwork on the east side of the flyover as well.



A City and County Agency

November 8, 2011

**Honorable Chair and
Members of the Sacramento Metropolitan Arts Commission**

Title: Approve Joyce Hsu's Conceptual Design for the Center Parkway Station and David Best's Conceptual Design for the Franklin Station. Regional Transit South Sacramento Corridor Phase 2 (RTSSCP2), District 7, Public Art Project.

Location/Council District: The RTSSCP2 District 7 project includes two new light rail stations; Center Parkway and Franklin. Both are located on Cosumnes River Boulevard between the Meadowview Station and Cosumnes River College.

Recommendation: APP Staff recommends approval of Joyce Hsu's conceptual design for the Center Parkway Station and David Best's conceptual design proposal for the Franklin Station.

Contact: Shelly Willis, Art in Public Places Director, (916) 808-3971
Suzy Vose, Art in Public Places Program, Project Manager (916) 808-3981

Description/Analysis

Issue: On October 7, 2010, an agreement was executed between the City of Sacramento and the Sacramento Regional Transit District (RT) for the Sacramento Metropolitan Arts Commission, Art in Public Places Program, to provide services to RT to administer the public art program for their RTSSCP2 Project. APP staff developed an art plan that was approved by RT and the APP Committee.

Two panels were composed to select artists for the projects:

1. District 7 projects for Franklin Station and Center Parkway Station
2. District 8 projects for Cosumnes River College Station and Cosumnes River Boulevard Flyover

A Request for Qualifications (RFQ), inviting qualified artists residing in Northern California to apply for all four project sites was distributed regionally. Fifty-nine artists were considered for the projects. On November 5, 2010, the District 7 panel reviewed the 59 applicants and selected seven finalists. On January 18, 2011, the District 7 panel met again, interviewed the finalists, and unanimously selected Joyce Hsu for the Center Parkway Station and David Best for the Franklin Station; each with a budget of \$56,000. On February 14, 2011, the Commission approved the selection of Joyce Hsu for the Center Parkway Station and David Best for the Franklin Station.

On September 8, 2011, Joyce Hsu presented a conceptual design titled, "Migration", and the panel voted unanimously to approve the design. On October 17, 2011, David Best presented a conceptual design, currently untitled, and the panel voted unanimously to approve the design.

District 7 (Center Parkway and Franklin Stations) Panelists:

1. Cheryl Holben, Arts Commissioner
2. Barbara Falcon, Community Representative
3. Michael Sweeney, Architect
4. Natalie Nelson, Director, Pence Gallery, Davis, CA
5. Eduardo Orozco, Asst Architect, Sacramento Regional Transit District
6. Bill Roach, Design Consultant, HLA

Policy Considerations: RT is not required by the APP Ordinance to participate in the 2% public art program. This is their voluntary contribution, due to their recognition of the value of public art for their business. The Commission’s approval of the artists’ conceptual design proposals for the RTSSCP2 District 7 Project meets standard APP policies and procedures and the goal of site-specific public art.

Commission Action: If the Commission approves the conceptual design proposals by Joyce Hsu and David Best, APP staff will submit this information to RT for their Board of Director’s information and approval. RT will prepare a final design contracts for Joyce Hsu and David Best.

Environmental Considerations: None

Rationale for Recommendation: To allow for public art that is integrated into the facility’s architecture or site plan, an artist needs to be under contract so that he/she may collaborate with the design team in a timely manner. Approving Joyce Hsu’s and David Best’s conceptual design proposals enables Regional Transit to initiate final design contracts for both artists.

Financial Considerations: Funding for the administration of the RT public art project is \$33,000 and the total project budget for RT is \$257,000.

Emerging Small Business Development (ESBD): N/A

Respectfully submitted by:

Shelly Willis, APP Director

Approved:

Rhyena Halpern, Executive Director

Attachments:

Attachment #1: Joyce Hsu’s Conceptual Design Proposal for Center Parkway Station titled “Migration”

Attachment #2: David Best’s Conceptual Design Proposal for Franklin Station (untitled)

**Attachment #1
Center Parkway Light Rail Station
RTSSCP2 Public Art Project**

**Conceptual Design Proposal
Migration, by Joyce Hsu**

Migration, is composed of three free standing aluminum Monarch butterflies mounted on steel structural supports on the edge of the station's shade structure. Monarch butterflies are noted for their lengthy annual migration. In North America they make massive southward migrations starting in August until the frost. The Sacramento area is part of this annual natural spectacle. Like the Monarch butterflies, thousands of commuters travel daily between one's place of residence and place of work or study. The average commuter may spend up to five hours a week in a transit station. The occasional discomfort and crowdedness of commuting can often overshadow the convenience and efficiency of the transit system. We often wish for a better, more personal experience. What if the commuters are presented with Monarch butterflies at the entrance of the station? Not only are these butterflies aesthetically intriguing, they are also a symbol for resilience. "Migration" is a sculpture that celebrates journeys taken every day and the simple beauty of everyday life.

The butterfly wings will be painted with the iconic orange and black just like Monarch butterflies. In addition to being highly visible, the warm orange color will also be the perfect background for shadows cast by the cut out pattern in the butterfly wings. The shadow created by the butterfly is an integral part of the concept and design of the piece. Instead of creating a kinetic sculpture, the butterflies will capture changing daylight, providing an otherwise static art work a sense of movement, which is perfect for a light rail station.

The sculpture's antennas, wing and legs will be fabricated of 1/8" aluminum. The body will be fabricated in 1/4". The support structure will be fabricated out of 4" diameter steel pipe. The entire sculpture will have a two-part polyurethane painted finish, similar to that of an automobile. Each of the three butterflies will be approximately 4'-8" wide and 3'-6" long on a support of approximately 2'-9" high.

Joyce Hsu is a sculptor, architect, and graphic designer who lives and works in Oakland, California. She earned a Master of Architecture from California College of the Arts, a Master of Fine Arts from San Francisco Art Institute, and a Bachelor of Fine Arts from Mount Allison University, Canada. A common thread that connects most of Hsu's artwork is the combination of nature and technology, which she describes as "organo-techno". Borrowing structural elements from aircraft and buildings, she uses high-tech fabrication techniques to create her sculptures. Hsu has been commissioned by the San Francisco Arts Commission for several public art projects including "Namoo House", a stainless steel and powder coated aluminum sculpture installed in 2008 at the San Francisco International Airport Terminal A, Gate 3. Her work has been exhibited at the Museum of Contemporary Art, San Diego; Institute of Contemporary Art, San Jose; San Jose Museum of Art; Yerba Buena Center for the Arts, San Francisco; New Langton Arts, San Francisco; Southern Exposure Gallery, San Francisco; and many others.

Attachment #2

Franklin Light Rail Station RTSSCP2 Public Art Project

Conceptual Design Proposal: David Best

The sculpture, fabricated of 1" plasma cut steel, is meant to be a gateway and beacon that welcomes and honors the diversity and hard work of the community. It will straddle the main walkway from the parking lot to the platform. While the shape is reminiscent of a temple, it is not meant to represent any particular religion or culture. Instead, it is meant to broadly welcome all cultures and invite individual interpretation.

What you don't see in the drawings is a text component. The text might be etched on a plaque that is installed next to the sculpture or set into the surface of hardscape. The text, as poetry, could be a simple series of sentences that begin with the words "I see". For example:

I see you have a family to take care of.
I see you traveling to work every day.
I see you searching for a better life.
I see you working hard.

The majority of the intricately cut-out steel will have a bronze colored patina, while smaller portions will have a silver tone and areas that would be most often touched will have a brass finish. The archway opening will be approximately 8' high by 12' wide. The tip of the spire will extend approximately 30' into the air.

Cut-outs will be sized so as not to encourage climbing. Maintenance for the sculpture will need to occur once or twice a year and will consist of power washing.

David Best is an internationally-renowned sculptor based in Petaluma, California. He earned a Master of Fine Arts degree from San Francisco Arts Institute. In the last ten years he has become best known for building immense temporary temples out of recycled wood for the Burning Man Festivals, in Black Rock City, Nevada. The temples, which are burned at the festival's conclusion each year, grew out of tragedy and immediacy when Best transformed his 2000 installation called the "Temple of the Mind" into an impromptu memorial for a friend who had died in the weeks just before the event. The next year, his similar but significantly expanded temporary structure called the "Temple of Tears", invited festival patrons to inscribe memories on the temple's wall and leave behind photos and other objects of personal significance and a tradition was born. Best may be equally well known for his "Art Cars" that have been exhibited around the country including at the San Francisco Museum of Modern Art, the Oakland Museum of California, the San Jose Museum of Art, and the di Rosa Preserve, in Sonoma, California. Best has received numerous private commissions, and several public commissions including a project titled, "Hayes Green Temporary Art Project #1", in San Francisco, a temple-like structure built entirely of recycled birch plywood from toy dinosaur model kits. The use of recycled material and sensitivity to both environment and the people who inhabit it, are common threads in David Best's work.

December 12, 2011

**Honorable Chair and
Members of the Sacramento Metropolitan Arts Commission**

Title: Approve or Make Recommendations on Mike Ross's Design Proposal for the Regional Transit South Sacramento Corridor Phase 2 (RTSSCP2) Station Platform Project, District 8, Public Art Project.

Location/Council District: The RTSSCP2, District 8, Public Art Project includes the Cosumnes River College (CRC) Light Rail Station that will be located on the CRC campus, just north of the east College Entrance off of Bruceville Road and the Cosumnes River Boulevard Flyover that will span the area above the intersection of Cosumnes River Boulevard and Bruceville Road; District 8.

Recommendation: Art in Public Places (APP) staff recommends approving Mike Ross's Design Proposal for the RTSSCP2, District 8, Station Platform, Public Art Project.

Contact: Shelly Willis, Art in Public Places Director, (916) 808-3971
Suzy Vose, Art in Public Places Program, Project Manager (916) 808-3981

Description/Analysis

Issue: In December, 2010, Mike Ross was selected as the artist for two sites at the RTSSCP2 Public Art Project. On June 13, 2011, the Commission granted the APP Committee authority to approve Mike Ross's Design Proposal for the RTSSCP2, District 8, Public Art Project, to allow the artist to prepare the construction and engineering details in time to be included in the RT bid package.

On July 21, 2011, the panel approved Mike's design proposals for the CRC Station and Cosumnes River Blvd. Flyover. On July 26, 2011, the APP Committee approved both design proposals.

Following the July 21 panel, CRC officials contacted Regional Transit staff and informed them that the pedestrian bridge site was not an eligible site for the artwork and the proposed design was unacceptable. Regional Transit, SMAC staff and the artist agreed the best way to proceed with this new information, would be to reconvene the panel and hear CRC officials concerns in a public meeting. On September 30, 2011, Mike Ross presented and discussed his proposal with CRC officials and the panel. CRC officials stated that they would not support his design on the pedestrian bridge. Furthermore, they were concerned that CRC was not represented adequately on the panel. Although a CRC faculty member and a CRC administrator were on the panel, CRC officials still did not feel represented.

RT and SMAC staff met with the artist after the meeting to determine how to proceed. Mike Ross agreed to redesign the artwork at another site for an additional design fee and RT agreed to pay the additional fee. SMAC staff also recommended CRC officials select another representative for the panel.

On December 9, 2011, Mike Ross presented his new design proposal to the panel. He also updated the panel on his design for the west side of the Cosumnes River Blvd Flyover. The panel included a newly appointed member, Dr. Deborah Travis, President of CRC. Dr. Travis replaced

Cory Wathen as the CRC representative.

The panel unanimously approved the new design for the CRC Station.

Ross updated them on the design for the Flyover. For aesthetic and budget reasons, Ross chose to site the flyover piece on the west side of the Flyover track. Although the panel and the APP Committee did not originally approve the piece contingent on its placement on the east or west side of the bridge, they felt it would be more visible if located on the east side. After reviewing the updated designs they supported the artist's decision to site the piece on the west side of the bridge. However, the panel noted they would strongly support additional artwork by Mike Ross for the east side of the light rail Flyover if RT is able to secure additional funding.

Policy Considerations: The Commission's approval of Mike Ross's Design Proposal for RTSSCP2, District 8, Public Art Project meets standard APP policies and procedures and the goal of site-specific public art.

Commission Action: None

Environmental Considerations: None

Rationale for Recommendation: Approving Mike Ross's design proposal for CRC Station and Cosumnes River Blvd Flyover enables RT staff to initiate the artist's final design contract.

Financial Considerations: Funding for the administration of the RT public art project is \$33,000 and the total project budget for RTSSCP2 is \$257,000. A funding line has been established for the \$33,000 as G17601900.

Emerging Small Business Development (ESBD): N/A

Respectfully submitted by,

Shelly Willis
Public Art Director

Approved by,

Rhyena Halpern
SMAC Executive Director

Attachments: 1. Project Background 4-3
2. Conceptual Design Proposals (untitled) 4-4

PROJECT BACKGROUND:

On October 7, 2010, an agreement was executed between the City of Sacramento and the Sacramento Regional Transit District (RT) for the Sacramento Metropolitan Arts Commission, Art in Public Places Program, to provide services to RT to administer the public art program for the RTSSCP2 Public Art Project.

APP staff developed an art plan that was approved by RT and the APP Committee. The Art Plan defines the four projects: Franklin Station, Center Parkway Station, CRC Station, and Cosumnes River Blvd Flyover.

A Request for Qualifications (RFQ), inviting qualified artists residing in Northern California to apply for all four projects, with a deadline to apply of October 27, 2010 was distributed regionally. Fifty-nine artists were considered for the projects.

Two panels were composed to select artists for the four projects: District 7 (Franklin Station and Center Parkway Station) and District 8 (CRC Light Rail Station and Cosumnes River Boulevard Flyover).

The District 8 panel met on November 4, 2010, reviewed the 59 applicants and selected the following six finalists:

1. Jenny Hale
2. Joyce Hsu
3. Mike Ross
4. Sheri Simons
5. Yoshio Taylor
6. Ann Weber

On December 3, 2010, the District 8 panel met again and interviewed these six artists. The panelists were asked to score the competing artists in rank order, 1-5 using standard Art in Public Places Program criteria for selection. The panel unanimously selected Mike Ross for the two RTSSCP2 sites, with a budget totaling \$112,000.

Budget:

Total RTSSCP2 Artwork Budget:	\$224,000 (\$56,000 for each of the four project sites)
Administration:	\$33,000
Mike Ross's Artwork Budget	\$112,000 (\$56,000 x 2)

Panelists for RTSSCP2, District 8 (Cosumnes River College sites):

1. John Nicolaus, Arts Commissioner
2. Margaret Woodcock, Art Professor, CRC, and Community Representative
3. Cory Wathen, Director of Administrative Services, CRC
4. Tim Foster, Artist and Editor of Midtown Monthly
5. Melissa Wood, Artist and Crocker Art Museum Associate
6. Tyler Babcock, Design Consultant, MFDB Architects
7. David Solomon, Senior Architect, Sacramento Regional Transit District

On March 2, 2011, Sacramento Regional Transit District executed a contract with Mike Ross to design a Conceptual Design Proposal for the CRC Light Rail Station and Cosumnes River Boulevard Flyover for a fixed price of \$8,000.

Attachment #2

Cosumnes River College Light Rail Station RTSSCP2 Public Art Project

Conceptual Design Proposal: Mike Ross

A sinuous, pencil-wide line weaves through the station and bus plaza, crossing all manner of surfaces: concrete platform, curbs and walls, precast concrete seats, brick walls, etc. Passengers may not notice the line at first, but eventually they will realize that its curvature distinguishes it from the rectilinear architectural elements of the station. Their curiosity may lead students and children to explore the length of the line.

The line is proposed to be made of stainless steel or anodized aluminum. The method of installation will vary as the line traverses different materials. The surface of the line will be flush with the surface of pavement and, where possible, with walls and other surfaces. The line will be kept at least 15' from the centerline of tracks to avoid requirements for electrical grounding. The variations in curvature of the line will relate it to the different sine waves used to generate the artwork on the Cosumnes River Boulevard Flyover.

Cosumnes River Boulevard Flyover

Conceptual Design Proposal: Mike Ross

In place of the standard metal bridge railing, a decorative fence is proposed for the west side of the flyover, where it spans Cosumnes River Boulevard. The fence will consist of two layers of painted metal bars, tall enough to be visible through the light rail vehicle windows. Each layer will have variation in spacing longitudinally (parallel to the bridge), transversely (the distance between the two layers), in curvature (thus not all bars are vertical), and in rotation (so the faces are not necessarily parallel to the face of the bridge). Each of these four attributes is varied in a different frequency, generated by a sine wave, so that when the frequencies are overlaid they create a non-repetitive moiré pattern.

The moiré effect shifts depending on the viewpoint of the observer. As motorists, pedestrians or light rail passengers move toward and along the bridge, they will see continuously changing patterns.

The artwork review panel and the Sacramento Arts Commission both recommended that, if RT has additional funds that can be applied to artwork, the artist be asked to extend the artwork to address the soundwall on the more visible east side of the flyover as well.

About the artist: Mike Ross is a conceptual sculptor from Berkeley, California. He earned a Bachelor of Science in Symbolic Systems from Stanford University. He is best known for "Big Rig Jig", commissioned by the Black Rock Arts Foundation for Burning Man in 2007. The gigantic sculpture of two modified tanker trucks attached to each other vertically in an S shape was featured on the front page of the New York Times. Ross described the work as a commentary on America's unsustainable oil economy. In 2008 Ross was hired by Sound Transit, Seattle, Washington's light rail agency, to design a sculpture for the Capitol Hill Station of its University Link project. His design features two fighter jets sliced and rearranged to appear as if they are kissing. Ross is a member of the International Sculpture Center, and a principal member of the Madagascar Institute, Brooklyn, New York. His work has been featured on the front page of the San Francisco Chronicle, the New York Times, as well as several other leading newspapers. Ross has received many awards for his artwork including 2010 Finalist Team Member for Build a Better Burb, Urban Design and first place in the Grand Esplande Award for his work titled, "Displacement", at Sculpture Key West 2009. In 2010 his work was shown in an exhibition titled "Conception" at Warehouse 16, Oakland, California, and in "Off the Grid", at 414 Space, Brooklyn, New York.